

ULTI-BOOM PRO - TELESCOPING

The Ulti-Boom Pro is one of the most secure booms in the industry. The clamping style mechanism and one-touch adjustment makes it easy to move the mic where it needs to be and hold it in place. To add even more strength, the main body of the boom is die-cast steel. It also includes a real counterweight, others are not much more than a handle. Whether on stage or in the studio, Ulti-Boom Pro will support your microphones.

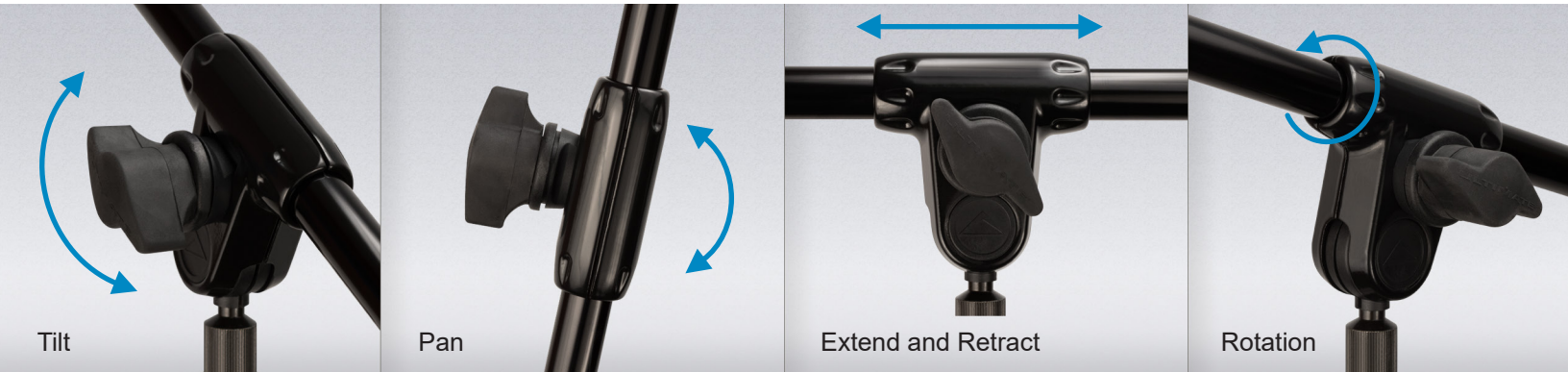
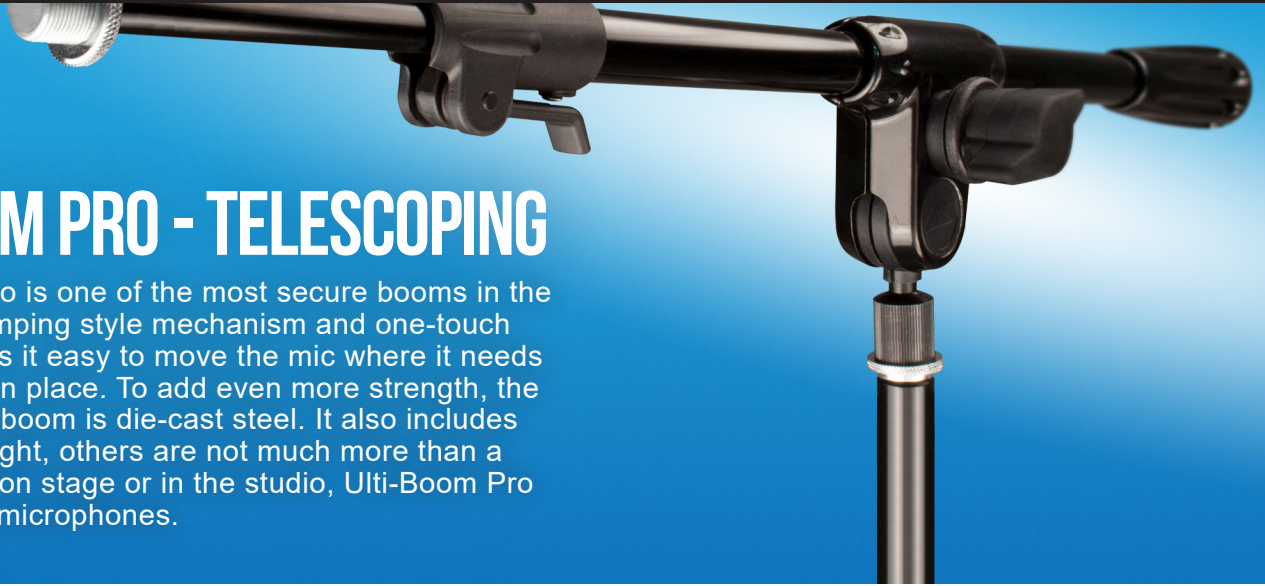

ONE-TOUCH ADJUSTMENT

With just one Z-Knob, you can take control of tilt (angle), pan (left to right), depth (toward or away from you), and rotation (twisting the mic one way or the other)!

LOCKS MICROPHONE IN PLACE

The main body of the boom clamps down on the tube, keeping the tube from slipping. Securely holds mic in place, no more drooping microphones.



HEAVY-DUTY COUNTERWEIGHT

Ulti-Boom Pro features a .65-pound die-cast zinc counterweight – not the cheesy, flimsy, plastic piece you see on all the other boom arms.

STABLELOCK LEVER

Stablelock lever provides fast telescoping adjustment and non-slip security.

Ulti-Boom Pro TB Specs

- Product Number: 17651
- Boom Length: 20"-35"
(508mm - 889mm)
- Counterweight: .65 lbs. (.3 kg)
- Weight: 1.95 lbs. (.9 kg)